

# ASME B16.48 LINE BLANKS FLANGES

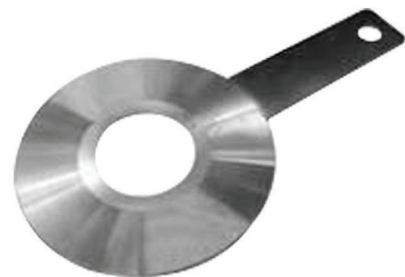

- Class 150 Flanges
- Class 300 Flanges
- Class 600 Flanges
- Class 900 Flanges
- Class 1500 Flanges
- Class 2500 Flanges



# ASME LINE BLANKS FLANGES

## CLASS 150 FLANGES

### ASME B16.48 LINE BLANKS

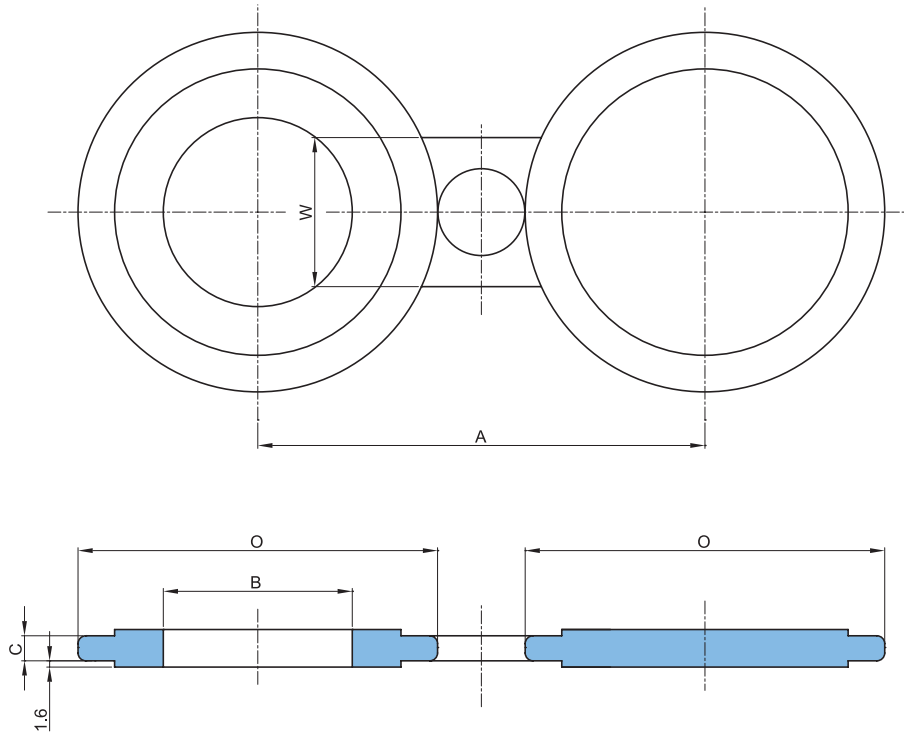

Unit : mm

Nominal Pipe Size	B	O	A	C	W
1/2	15.7	44.5	60.5	3.0	38.1
3/4	20.8	53.8	69.9	3.0	38.1
1	26.7	63.5	79.2	3.0	38.1
1 1/4	42.2	73.2	88.9	6.4	38.1
1 1/2	48.3	82.6	98.6	6.4	38.1
2	60.5	101.6	120.7	6.4	50.8
2 1/2	73.2	120.7	139.7	6.4	50.8
3	88.9	133.4	152.4	6.4	63.5
3 1/2	101.6	158.8	177.8	9.7	63.5
4	114.3	171.5	190.5	9.7	63.5
5	141.2	193.5	215.9	9.7	76.2
6	168.1	218.9	241.3	12.7	76.2
8	218.9	276.4	298.5	12.7	76.2
10	273.1	336.6	362.0	15.7	101.6
12	323.9	406.4	431.8	19.1	101.6
14	355.6	447.5	476.3	19.1	108.0
16	406.4	511.0	539.8	22.4	108.0
18	457.2	546.1	577.9	25.4	114.3
20	508.0	603.3	635.0	28.4	120.7
24	609.6	714.2	749.3	31.8	139.7

# CLASS 300 FLANGES

## ASME B16.48 LINE BLANKS

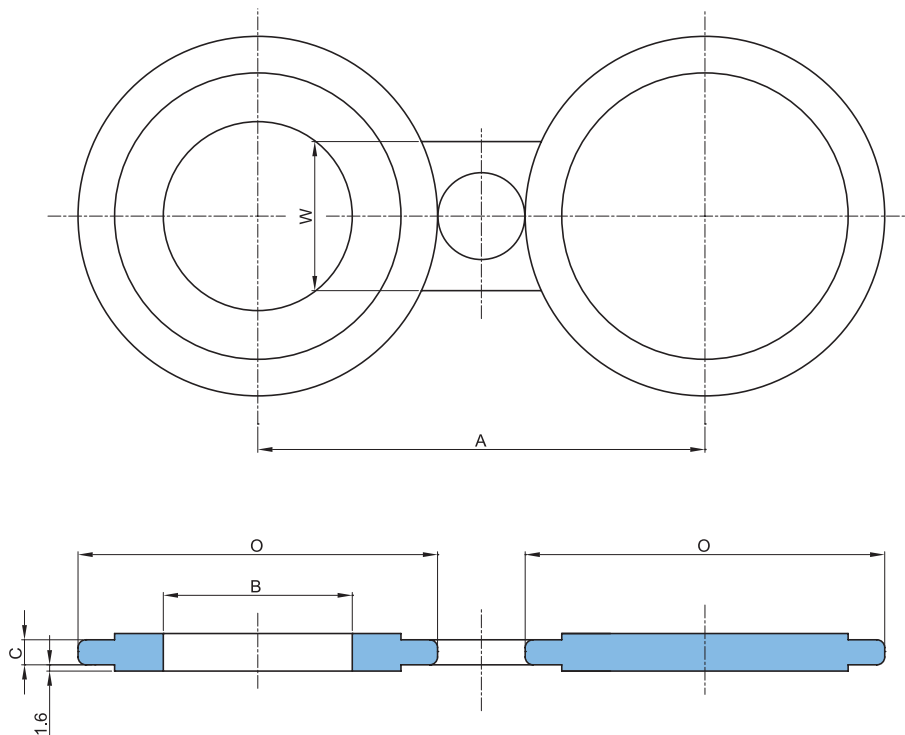

Unit : mm

Nominal Pipe Size	B	O	A	C	W
1/2	15.7	50.8	66.5	6.4	38.1
3/4	20.8	63.5	82.6	6.4	38.1
1	26.7	69.9	88.9	6.4	38.1
1 1/4	42.2	79.2	98.6	6.4	38.1
1 1/2	48.3	91.9	114.3	6.4	38.1
2	60.5	108.0	127.0	9.7	50.8
2 1/2	73.2	127.0	149.4	9.7	50.8
3	88.9	146.1	168.1	9.7	63.5
3 1/2	101.6	162.1	184.2	12.7	63.5
4	114.3	177.8	200.2	12.7	63.5
5	141.2	212.9	235.0	15.7	76.2
6	168.1	247.7	269.7	15.7	76.2
8	218.9	304.8	330.2	22.4	76.2
10	273.1	358.6	387.4	25.4	101.6
12	323.9	419.1	450.9	28.4	101.6
14	355.6	482.6	514.4	31.8	108.0
16	406.4	536.4	571.5	38.1	108.0
18	457.2	593.9	628.7	41.1	114.3
20	508.0	650.7	685.8	44.5	120.7
24	609.6	771.7	812.8	50.8	139.7

# ASME LINE BLANKS FLANGES

## CLASS 600 FLANGES

### ASME B16.48 LINE BLANKS

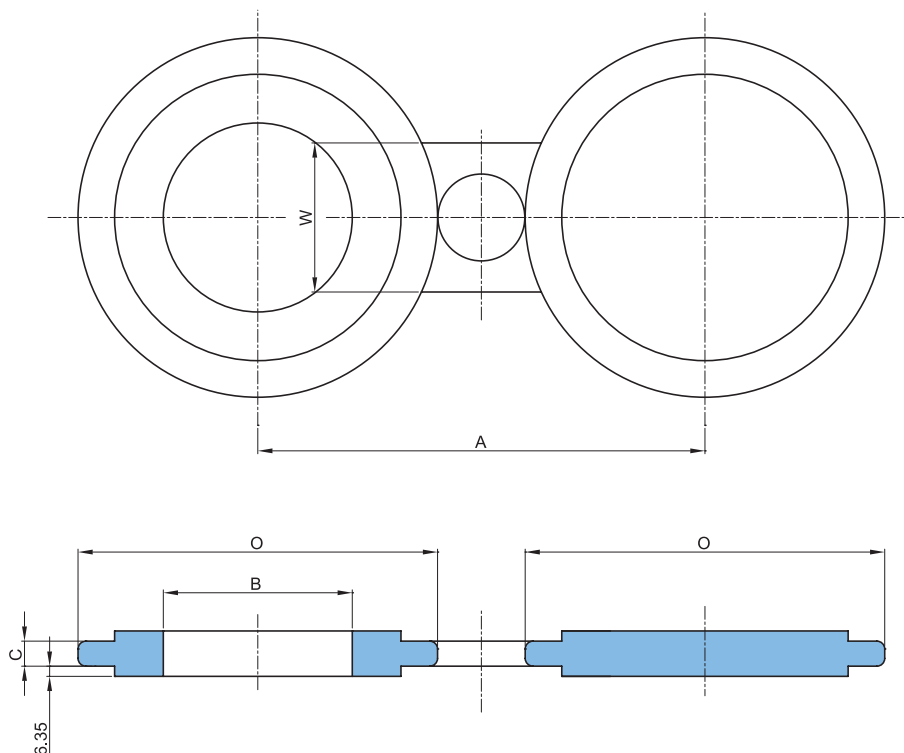

Unit : mm

Nominal Pipe Size	B	O	A	C	W
1/2	15.7	50.8	66.5	6.4	38.1
3/4	20.8	63.5	82.6	6.4	38.1
1	26.7	69.9	88.9	6.4	57.2
1 1/4	36.6	79.2	98.6	9.7	57.2
1 1/2	42.7	91.9	114.3	9.7	66.5
2	54.9	108.0	127.0	9.7	57.2
2 1/2	67.1	127.0	149.4	12.7	66.5
3	82.8	146.1	168.1	12.7	66.5
3 1/2	95.5	158.8	184.2	15.7	76.2
4	108.2	190.5	215.9	15.7	76.2
5	134.6	238.3	266.7	19.1	85.9
6	161.5	263.7	292.1	22.4	85.9
8	211.6	317.5	349.3	28.4	95.3
10	264.7	396.7	431.8	35.1	104.6
12	314.7	454.2	489.0	41.1	104.6
14	345.9	489.0	527.1	44.5	114.3
16	396.7	561.8	603.3	50.8	124.0
18	447.5	609.6	654.1	53.8	133.4
20	496.8	679.5	723.9	63.5	133.4
24	596.9	787.4	838.2	73.2	152.4

# CLASS 900 FLANGES

## ASME B16.48 LINE BLANKS

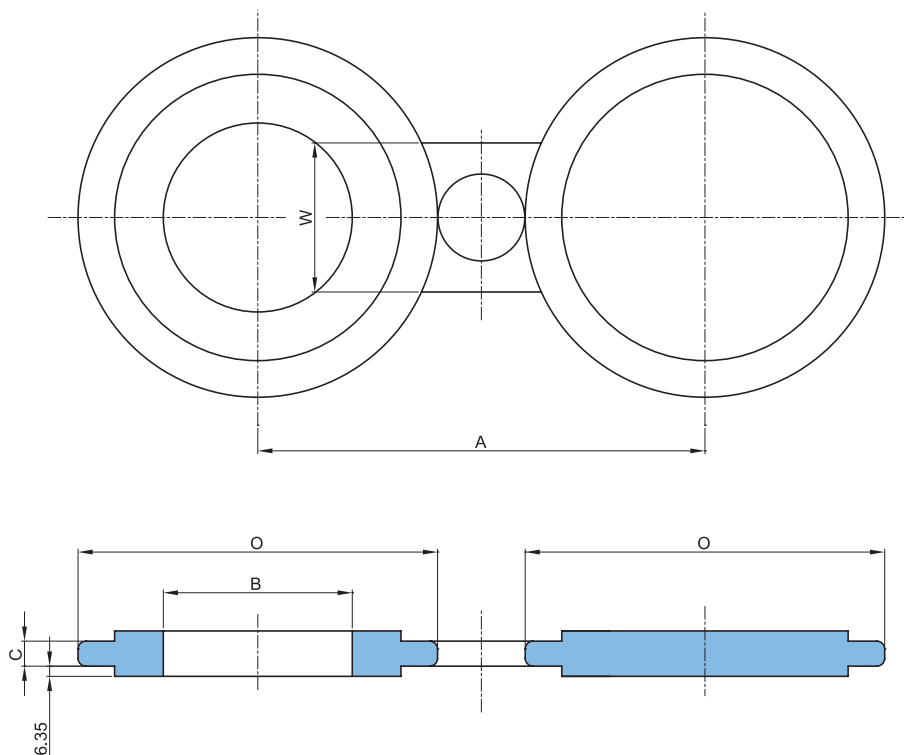

Unit : mm

Nominal Pipe Size	B	O	A	C	W
1/2	15.7	60.5	82.6	6.4	38.1
3/4	20.8	66.5	88.9	6.4	41.1
1	26.7	76.2	101.6	6.4	57.2
1 1/4	36.6	85.9	111.3	9.7	57.2
1 1/2	42.7	95.3	124.0	9.7	66.5
2	54.9	139.7	165.1	12.7	57.2
2 1/2	67.1	162.1	190.5	12.7	66.5
3	82.8	165.1	190.5	15.7	66.5
4	108.2	203.2	235.0	19.1	76.2
5	134.6	244.3	279.4	22.4	85.9
6	161.5	285.8	317.5	25.4	85.9
8	211.6	355.6	393.7	35.1	95.3
10	264.7	431.8	469.9	41.1	104.6
12	314.7	495.3	533.4	47.8	104.6
14	345.9	517.7	558.8	53.8	114.3
16	396.7	571.5	616.0	60.5	124.0
18	447.5	635.0	685.8	66.5	133.4
20	496.8	695.5	749.3	73.2	133.4
24	596.9	835.2	901.7	88.9	152.4

# ASME LINE BLANKS FLANGES

## CLASS 1500 FLANGES

### ASME B16.48 LINE BLANKS

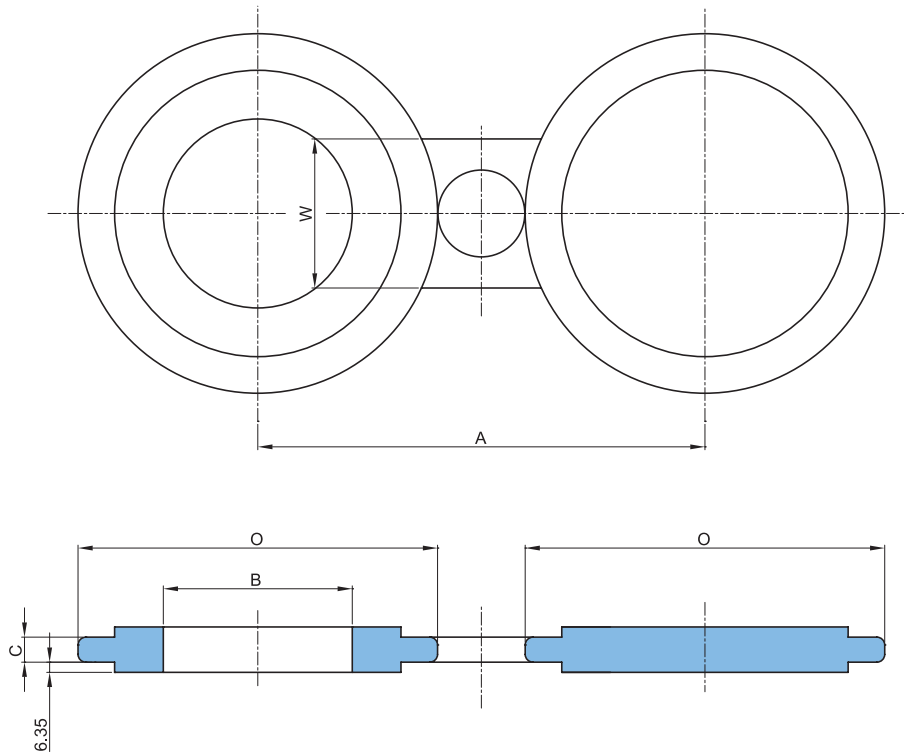

Unit : mm

Nominal Pipe Size	B	O	A	C	W
1/2	15.7	60.5	82.6	6.4	38.1
3/4	20.8	66.5	88.9	9.7	41.1
1	26.7	76.2	101.6	9.7	55.9
1 1/4	35.1	85.9	111.3	9.7	63.5
1 1/2	40.9	95.3	124.0	12.7	69.9
2	52.6	139.7	165.1	12.7	69.9
2 1/2	62.7	162.1	190.5	15.7	76.2
3	78.0	171.5	203.2	19.1	76.2
4	102.4	206.2	241.3	22.4	88.9
5	128.3	251.0	292.1	28.4	88.9
6	153.9	279.4	317.5	35.1	88.9
8	202.7	349.3	393.7	41.1	101.6
10	254.5	431.8	482.6	50.8	114.3
12	303.3	517.7	571.5	60.5	114.3
14	333.2	574.5	635.0	66.5	127.0
16	381.0	638.0	704.9	76.2	133.4
18	428.8	701.5	774.7	85.9	146.1
20	477.8	752.3	831.9	95.3	152.4
24	574.5	898.7	990.6	111.3	177.8

# CLASS 2500 FLANGES

## ASME B16.48 LINE BLANKS

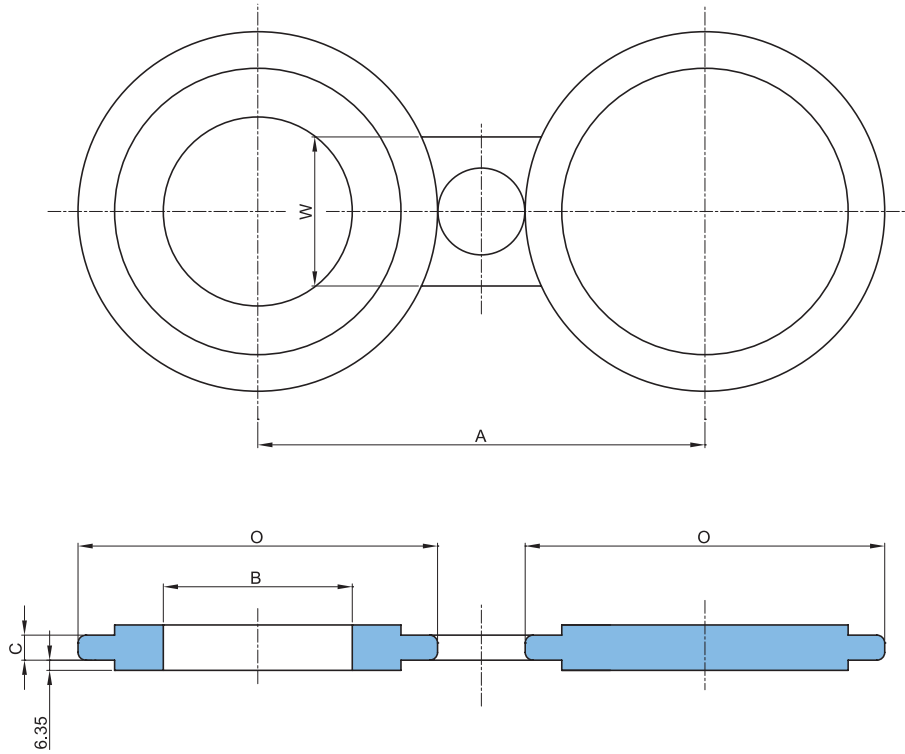

Unit : mm

Nominal Pipe Size	B	O	A	C	W
1/2	15.7	66.5	88.9	9.7	38.1
3/4	20.8	73.2	95.3	9.7	41.1
1	26.7	82.6	108.0	9.7	63.5
1 1/4	35.1	101.6	130.0	12.7	63.5
1 1/2	40.9	114.3	146.1	15.7	69.9
2	52.6	142.7	171.5	15.7	69.9
2 1/2	62.7	165.1	196.9	19.1	76.2
3	78.0	193.5	228.6	22.4	76.2
4	102.4	231.6	273.1	28.4	88.9
5	128.3	276.4	323.9	35.1	88.9
6	153.9	314.5	368.3	41.1	88.9
8	198.4	384.0	438.2	53.8	101.6
10	247.7	472.9	539.8	66.5	114.3
12	288.8	546.1	619.3	79.2	114.3